

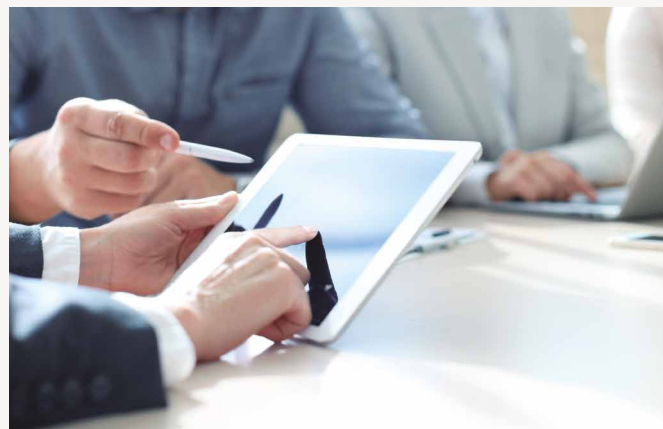

ROYAL PACIFIC
HOTEL



Photos are for reference only



HOST YOUR SUCCESSFUL MEETINGS WITH US

With contemporary venues, sumptuous dining experience and state-of-the-art facilities, Royal Pacific Hotel promises you and your meeting delegates a memorable meeting experience.

Package	Price (per person)	Duration	20-minute coffee break session	Lunch
Full Day	HK\$750	9am - 5pm	2	Chinese or Western
Full Day	HK\$600	9am - 5pm	2	/
Half Day	HK\$650	9am - 1pm or 1pm - 5pm	1	Chinese or Western
Half Day	HK\$400 (15 - 50 persons) HK\$300 (50 persons or above)	9am - 1pm or 1pm - 5pm	1	/

Packages include :

- WiFi access
- Use of LCD projector with screen
- Standard PA system with microphones and CD / DVD player
- Meeting amenities include flipcharts, markers, notepads, pens, refreshing mints and iced water

For enquiries, please contact our Catering Department.
T (852) 2738 2236 E catering@royalpacific.com.hk
China Hong Kong City, 33 Canton Road, Tsimshatsui, Kowloon, Hong Kong
  RoyalPacificHotel  sinohotels www.royalpacific.com.hk

 SINO HOTELS

Pacific Room 9th Floor (Towers Wing)

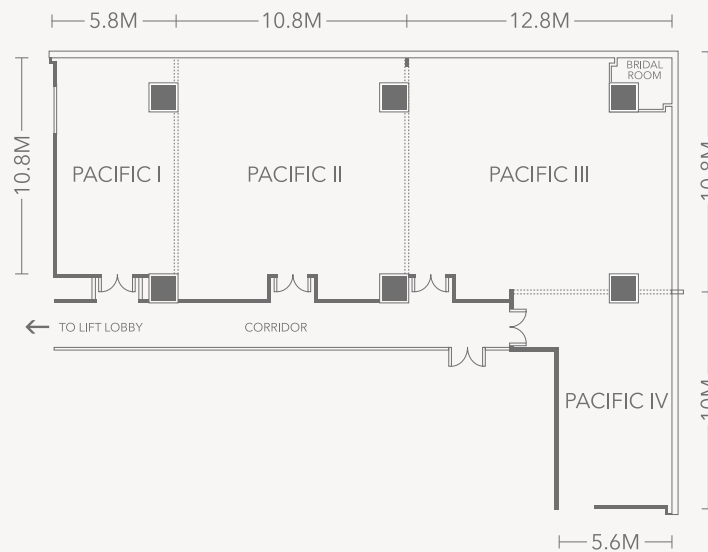

Imperial Room Mezzanine Floor (Towers Wing)

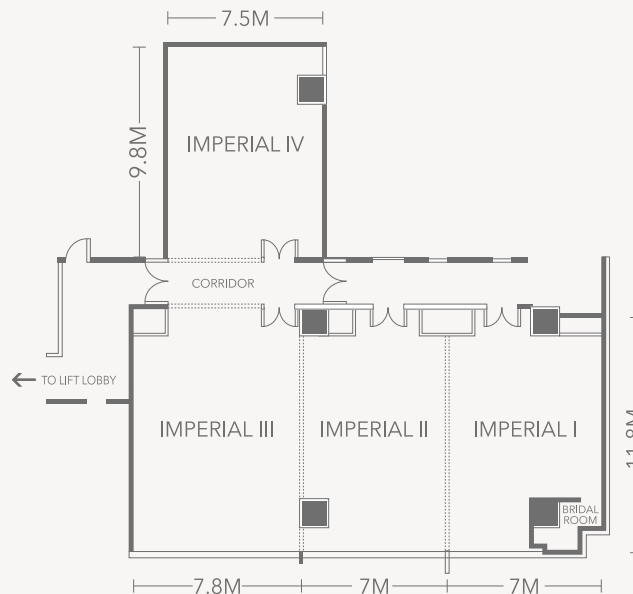

Terms and Conditions:

- The above packages are valid until 31 December 2021 and subject to availability
- All prices are on per person per day basis
- Offers are subject to 10% service charge based on original prices
- A minimum of 12 persons is required
- Applicable for events organised by corporations and associations
- Free cancellation with a minimum of 3 working days' advance notice
- Minimum spending of food & beverage waived
- No deposit is required