



ROYAL PACIFIC  
HOTEL



## BESPOKE RESIDENTIAL MEETING PACKAGE

Strategically located at a prime spot in Tsim Sha Tsui, Royal Pacific Hotel offers flexible meeting venues with well-equipped facilities, exquisite guestrooms and unparalleled dining options, all that contribute to this perfect platform for business events of any scale, from an intimate seminar to a major conference.

**HK\$1,000 per person**

### Exclusive privileges:

- One night stay in a Premier Room
  - Full day meeting room rental with standard meeting equipment, one coffee break and refreshments
  - Lunch buffet at Café on the PARK
  - Complimentary WiFi access
  - 24-hour Fitness Centre
- Special price for accompanying meeting delegates at HK\$500 per person

### Terms & conditions:

- The offer is valid from now until 31 December 2019
- Prices are subject to 10% service charge
- A minimum of 15 persons is required
- Room rate is on per room per night basis
- Special price is on per person basis and is applicable to any additional accompanying meeting delegate who does not require accommodation
- Offer is applicable to new bookings only
- Offer cannot be used in conjunction with any other discount or promotional offers
- The offer is subject to room and meeting venue availability
- Prices are subject to change without prior notice
- Photos are for reference only
- In case of any dispute, Royal Pacific Hotel reserves the right to make a final decision



## Pacific Room 9<sup>th</sup> Floor (Towers Wing)

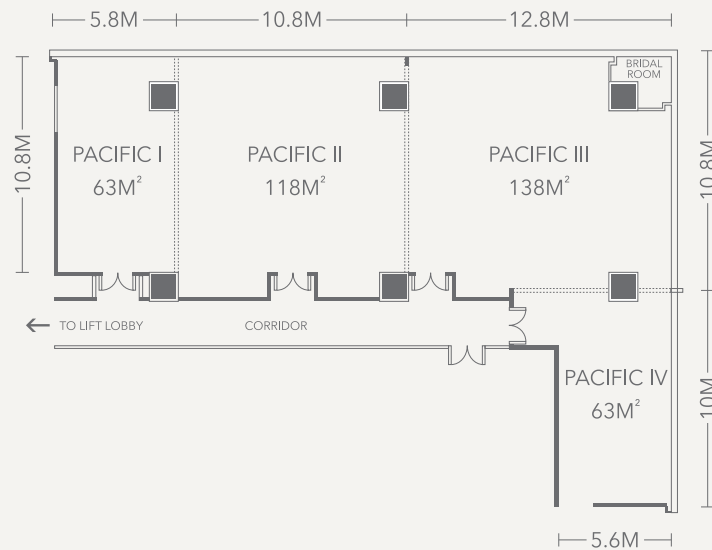

## Imperial Room Mezzanine Floor (Towers Wing)

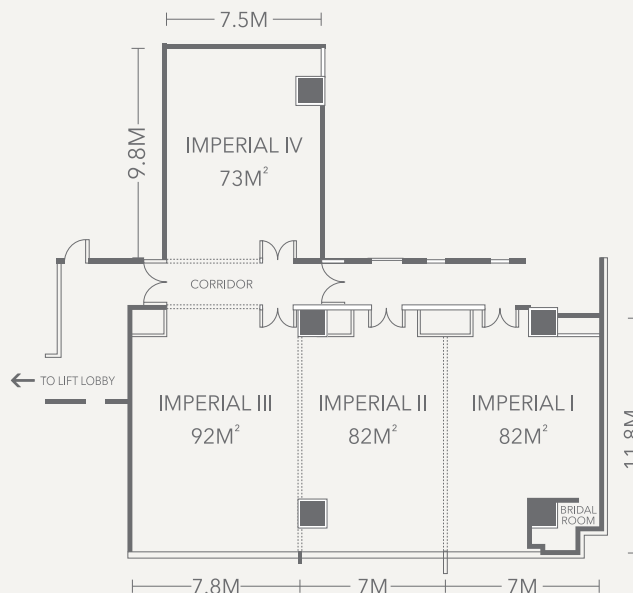

For reservations:  
T (852) 2738 2243 [www.royalpacific.com.hk](http://www.royalpacific.com.hk) [catering@royalpacific.com.hk](mailto:catering@royalpacific.com.hk)  
China Hong Kong City, 33 Canton Road, Tsimshatsui, Kowloon, Hong Kong  
© RoyalPacificHotel